



1. APPLICATIONS

Control panel for 1 motor at 24 Vdc, with integrated radio receiver and encoder. It enables manage buffer stop at the end each move and obstacle detection. Also available in 12Vdc version

2. OPERATING INSTRUCTIONS

The maneuvers are executed through the START button (21-22) or by radio card). The maneuvers ends for one of the following conditions: activation of the corresponding end switches or by the end of operating time.

If during the opening operation is given an order, the action is stoped and do not run the closing.

Stop (18-19) activation stops immediatly La activación del Paro (18-19) causes the immediate stop of the maneuver, being necessary an order for the resumption of it.

Stop button activation causes immediate stop of the maneuver, requiring an order for the resumption of it.

Activation the photocell input (12-13) during closing, inverts it and goes to open position.

Garage light is activated during 3 minutes after starting the maneuver.

Pedestrian push button (20-21) drives the door opening for pedestrian use.

3. CONNECTIONS

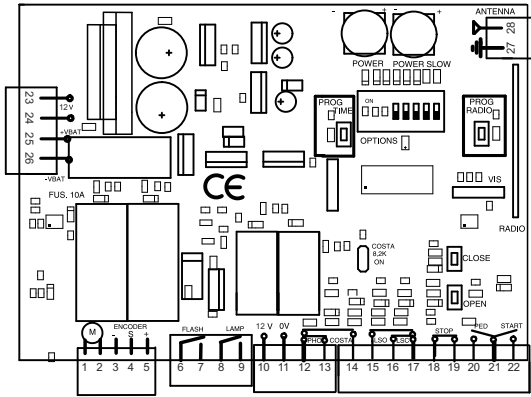

3.1 STANDARD CONTROL PANEL SET UP

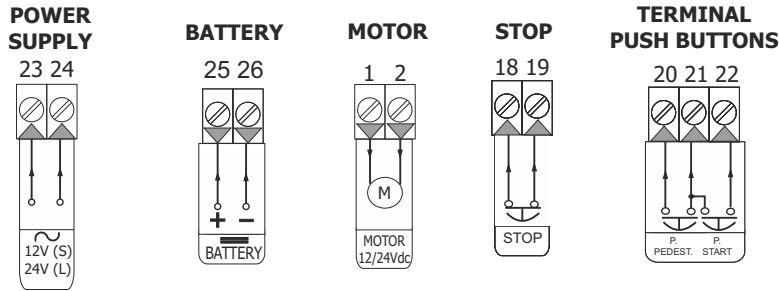

3.2 TERMINAL DESCRIPTION

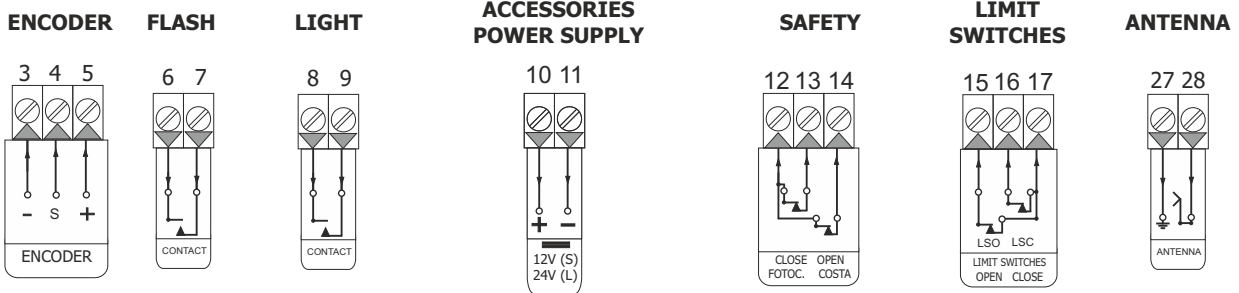

4. REGULATIONS

STRENGTH MOTOR REGULATION (RED)

















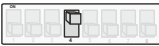

Regulation the strength of motor. Rotate LEFT to decrease and rotate RIGHT to increase.

DRIVE POWER (OPTION 7 ON) (GREEN)



Regulates drive power. Turn LEFT to decrease and RIGHT to increase.

5. OPTIONS

1	GARAGE - BARRIER / SLIDING		- Garage - Barrier.
			- Sliding.
2	AUTOMATIC CLOSING		- Door closes automatically after waiting the a.c. time.
			- Door does not close automatically.
3	DOOR STOP & INVERTS AND DISABLE STOP OPENING		- Alternative button START (21-22) stops and inverts at closing. Disable stop
			- Alternative button START (21-22) stops.
4	DRIVE DIRECTION		- Normal drive direction.
			- Invert drive direction.
5	PNEUMATIC BAND WITH STOP OPTIONS		- COSTA input (12-14) works like 8K2 safety band, stopping & reversing the maneuver at opening and closing.
			- La entrada COSTA (12-14) works like safety photocell, stopping the maneuver at opening.
6	FLASHING LIGHT		- Flashing.
			- Fixed.
7	BUFFER CLOSING		- Drive reduce it's speed at the end of opening & closing. (see point 7. for buffer closing time programming).
			- No buffer.
8	ENCODER YES / NO		- Enable encoder input.
			- Disable encoder input.

6. PROGRAMING A TRANSMITTER

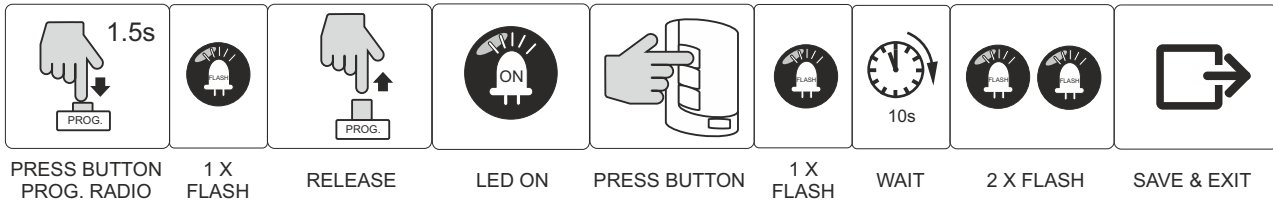

6.1 TRANSMITTER RADIO PROGRAMMING

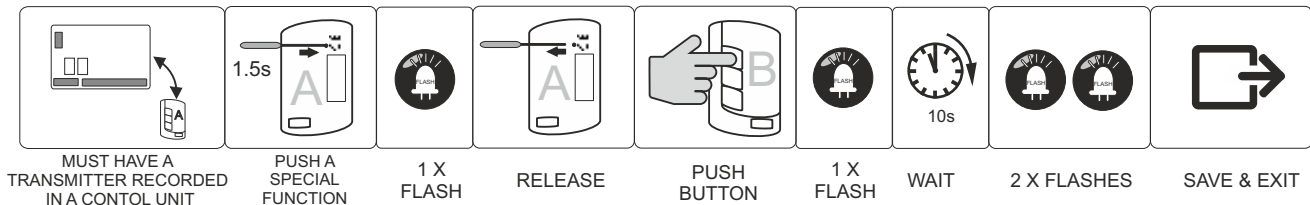

6.2 MEMORY RESET

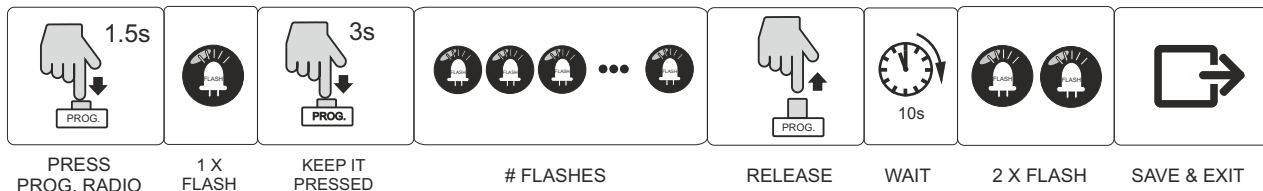

7. DIGITAL TIME PROGRAMMING

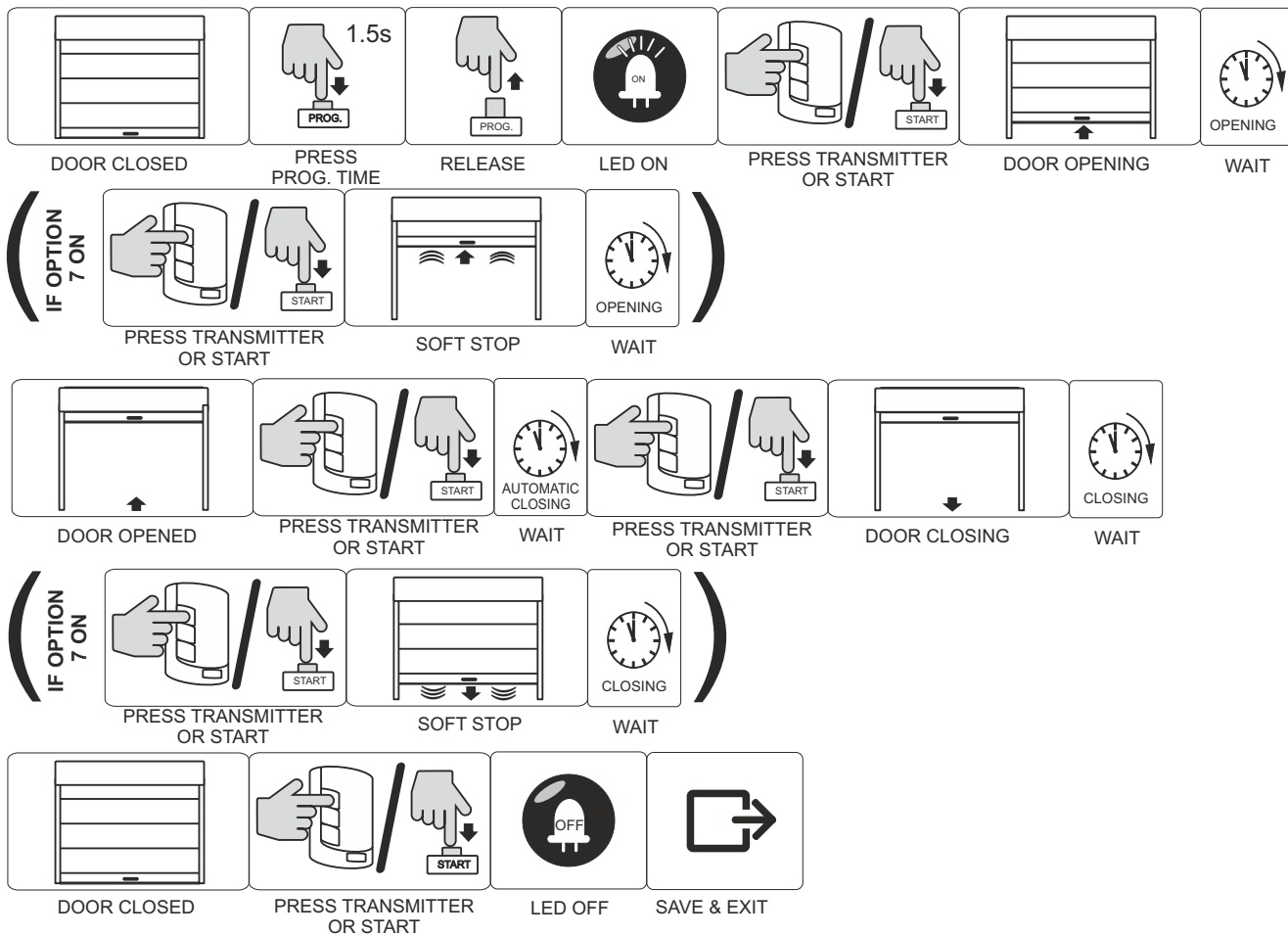

8. BOX HOUSING

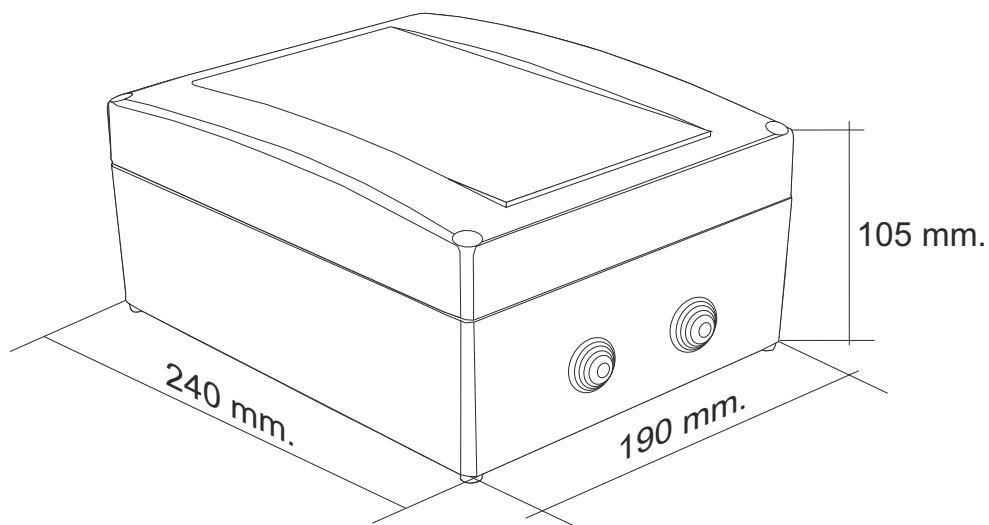

TECHNICAL SPECIFICATIONS

Power Supply	12V AC (S) / 24V AC (L)
Power Supply for Motor	12V DC (S) / 24V DC (L)
Motor Current	2,5A
Output Accessory	12V (S) 24V (L) DC 150mA
Light	Contact N.O.
Flash	Contact N.O.
Working Time	2 minutes
Automatic Closing Time	3 sec. a 2 minutes
Radio Card	Internal (433,92 or 868,35 MHz)
Working Temperature	-20 to 70°C

CE DECLARATION OF CONFORMITY

Aplicaciones electrónicas y de Radiofrecuencia S.L. Pol. Sot dels Pradals C/ Sot dels pradals, 4 08500 Vic (Barcelona) B61840732 DECLARES, under her own responsibility that product It is designed and manufactured in accordance with the directives LV 2006/95/CE of Low Voltage, EMC 2004/108/CE of Electromagnetic Compatibility, 2006/42/CE Machines directive and is designed to control doors in accordance with standard EN13241-1 (2004) and complies with the requirements of the R&TTE 99/05/CE European parliament directive of March 9th 1999. This directive was transposed to the Spanish legislation by means of Real Decree 1890/2000 in November 20th of 2000, directive 1999/5/CE spectrum radio electric protection, electromagnetic compatibility directive 2004/108/CE. **For more information visit the website www.aerf.eu**

WARNING!!

- Equipment installation and start-up, can only be executed by qualified personal.

